

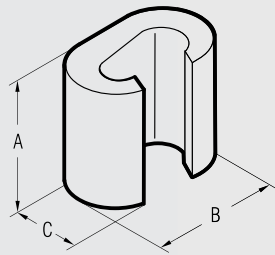

SLEEVE CONNECTORS

bright surface version



Conductor Size sqmm		Ref.	Dimensions mm			Quantity Box/Bag	Mechanical Tools	Hydraulic Tools	
Run	Tap		A	B	C				
6÷2,5	6÷1,5	C 6-C 6	9,0	9,8	6,4	1.000/100	HP4-C10		
10	10÷1,5	C 10-C 10	12,0	12,6	8,4	500/100			
16	16÷1,5	C 16-C 16	17,0	19,4	12,0	500/100	B 35-45D B 35-50D	HT 45-E	RH 50 B 51 B 55
25÷16	10÷1,5	C 25-C 10	17,0	19,8	13,0	400/50			
25	25÷16	C 25-C 25	17,0	21,4	13,0	300/50	HT 51	RH 50 B 51 RHU 81	ECM-H3D
40÷35	16÷1,5	C 35-C 16	21,0	24,6	15,4	200/25			
40÷35	40÷25	C 35-C 35	21,0	26,6	15,6	200/25	HT 81-U	RHU 81	HT 120 and tools and heads with 130 kN crimping force
50	25÷10					200/25			
50	25÷4	C 50-C 25	25,0	32,9	21,0	200/25	HT 51	RH 50 B 51	ECM-H3D
50	50÷35	C 50-C 50	26,0	33,0	21,0	100/25			
70÷63	25÷1,5	C 70-C 25 N	21,0	26,4	17,5	100/25	HT 51	RH 50 B 51	ECM-H3D
70÷50	40÷4	C 70-C 35	28,0	33,0	21,0	100/25			
70÷50	70÷35	C 70-C 70	28,0	34,0	21,0	100/25	HT 51	RH 50 B 51	ECM-H3D
100÷95	40÷4	C 95-C 35	29,0	40,6	26,0	50/25			
100÷95	70÷40	C 95-C 70	29,0	41,0	26,0	50/25	HT 51	RH 50 B 51	ECM-H3D
100÷95	100÷63	C 95-C 95	29,0	41,0	26,0	50/25			
125÷110	125÷25	C 120-C 120	30,0	45,0	28,0	50/25	HT 51	RH 50 B 51	ECM-H3D
160÷150	125÷25	C 150-C 120	31,0	45,0	28,0	50/25			
150	150÷63	C 150-C 150	30,0	45,0	28,0	50/25	HT 51	RH 50 B 51	ECM-H3D
185	100÷16	C 185-C 95	31,0	45,0	28,0	50/25			
185÷120	185÷120	C 185-C 185	22,6	68,0	34,0	30/15	HT 51	RH 50 B 51	ECM-H3D
240÷150	120÷95	C 240-C 120	22,6	68,0	34,0	30/15			

Featuring same characteristics as tin plated version, (see opposite page).