

ITK INDOOR TERMINATIONS

Up to 24 kV

Application

A kit of 3 terminations for use indoors in controlled environmental conditions and subject to light condensation. To connect polymeric insulated cable to equipment.

6/10 (12) kV
6.35/11 (12) kV
8.7/15 (17.5) kV
12/20 (24) kV
12.7/22 (24) kV

Design

Indoor termination comprising:

1. Cable lug (not included in the standard kit).
2. Water sealing mastic.
3. Silicone tube.
4. Stress control mastic.
5. Conductive EPDM ring.

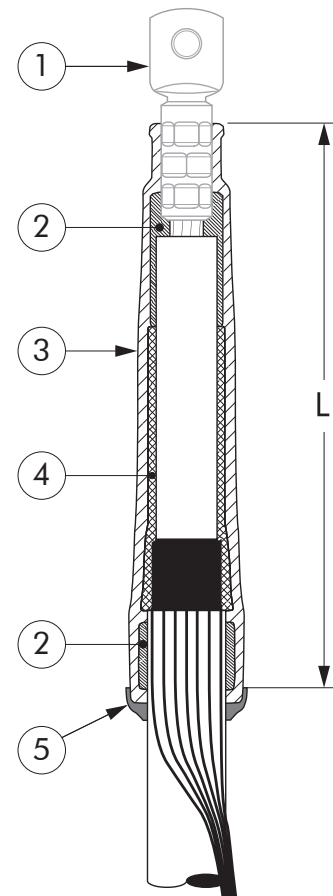

Specifications and standards

Meets the requirements of CENELEC HD 629.1.

Termination type	Voltage U_m (kV)	Strike distance L (mm)	Diameter over core insulation (mm)		Conductor sizes (mm ²)	
			min.	max.	min.	max.
ITK 212	12	260	14	33	50	400
ITK 312	12	300	30	50	400	1000
ITK 224	24	260	14	33	25	240
ITK 324	24	300	30	50	300	800

01/2010

Kit contents

The complete ITK termination kit comprises the following components:

The kit also comprises water sealing mastic and installation instructions.

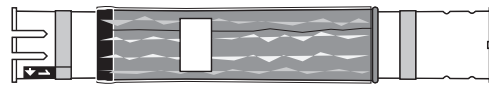

3 x Factory preassembled silicone tubes comprising stress relief and sealing mastic.

= 3 x ITK 212 or ITK 224 termination kit

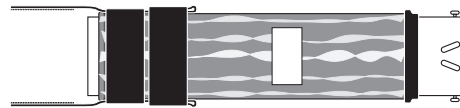

3 x Factory preassembled silicone tubes comprising stress relief and sealing mastic.

= 3 x ITK 312 or ITK 324 termination kit

Ordering instructions

Select the part number corresponding to both the system voltage and the cable insulation diameter in mm.

Ordering part number	Voltage Um (kV)	Diameter over core insulation (mm)		Conductor sizes (mm ²)	
		min.	max.	min.	max.
3 x ITK 212	12	14	33	50	400
3 x ITK 312	12	30	50	400	1000
3 x ITK 224	24	14	33	25	240
3 x ITK 324	24	30	50	300	800

Example:

The copper wire screened cable is 12 kV, 150 mm² stranded aluminium.

The diameter over core insulation is 26.2 mm.

Order a 3 x ITK 212 termination kit.

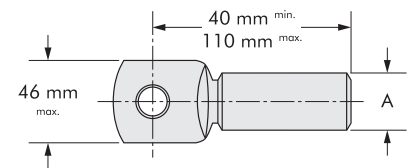

All commercialised European standard cable lugs can be used.

Cable lugs should be within the dimensions specified (not applicable for ITK 312 and ITK 324).

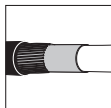

For use with copper wire screened cables. No earthing device is necessary.

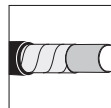

For use with copper tape screened cables. Also order a Kit MT.

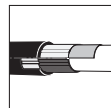

For use with Alupe or C 33-226 cables. Please contact our representative.



For use with three-core cables: see T-ITK.

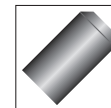

If the cable lug barrel diameter (A) is less than 20 mm: order a rubber adapting sleeve.

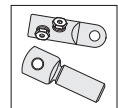

Can be supplied with all common types of cable lugs.